

Component Locations			
Description	Part Number	Machine Location	Schematic Location
Attachment: Universal Quick Coupler			
Connector As - Quick Coupler	148-8321	1	E-2
Valve Gp - Check (Quick Coupler)	123-4750	2	B-2
Valve Gp - Shuttle (Quick Coupler)	123-2549	3	C-5
Valve Gp - Quick Coupler	254-3080	4	E-2
Valve Gp - Solenoid (Quick Coupler)	258-6749	5	E-2
Standard Machine			
Accumulator Gp	Note B	20	A-4
Block	Note B	21	D-7
Cylinder Gp - Boom	Note A	22	E-6
Cylinder Gp - Bucket	Note A	23	E-7
Cylinder Gp - Stick	Note A	24	E-7
Filter Gp - Case Drain	Note B	25	A-6
Filter Gp - Pilot Hydraulic	Note B	26	A-3
Filter Gp - Return Oil	Note B	27	A-6
Manifold Gp - Control	Note B	28	B-4, B-5
Motor Gp - Swing	Note B	29	F-5
Motor Gp - Travel Left	Note B	30	F-4
Motor Gp - Travel Right	Note B	31	F-3
Pump Gp - Main Hydraulic	Note B	32	B-2
Sensor As - Left Pump Pressure	Note B	33	B-3
Sensor As - Right Pump Pressure	Note B	34	A-3
Switch As - LH Travel Pressure	Note B	35	D-7
Switch As - Pilot Pressure	Note B	36	B-7
Switch As - RH Travel Pressure	Note B	37	D-6
Swivel Gp	Note B	38	E-4
Tank Gp - Hydraulic Oil	Note B	39	A-4
Valve Gp - Cooler Bypass	Note B	40	B-7
Valve Gp - Heavy Lift Solenoid	Note B	41	B-3
Valve Gp - LH Joystick	Note B	42	C-7
Valve Gp - Load Control Boom Cylinder	Note B	43	D-2
Valve Gp - Load Control Stick Cylinder	Note B	44	D-5
Valve Gp - Main Control	Note B	45	C-2 thru C-8
Valve Gp - Pilot Travel	Note B	46	D-6, D-7
Valve Gp - Press Reducing Boom/Swing	Note B	47	B-3
Valve Gp - Press Reducing Boom/Swing	Note B	48	B-4
Valve Gp - RH Joystick	Note B	49	C-6
Valve Gp - Shuttle	Note B	50	C-8, C-7
Valve Gp - Swing Cushion	Note B	51	E-5
Valve Gp - Travel LT Counterbalance	Note B	52	E-4
Valve Gp - Travel RT Counterbalance	Note B	53	E-3

NOTE A: Check the parts manual for the correct cylinder part number.
 NOTE B: Check the parts manual or the Standard Machine Hydraulic Schematic for specific part numbers that match the efficiency of the machine.

Tap Locations Pressure, Sampling, and Sensor		
Tap Number	Description	Schematic Location
EE	Left Pump Delivery Pressure	B-2
FF	Right Pump Delivery Pressure	A-2
GG	Pilot Pump Delivery Pressure	A-3
HH	Left Pump Power Shift Pressure	B-2
JJ	Case Drain Pressure	B-2
KK	Right Pump Power Shift Pressure	A-2
LL	Quick Coupler Unlock Pressure	C-3
MM	Quick Coupler Lock Pressure	E-2
SOS	Hydraulic Oil Sampling Port	A-3

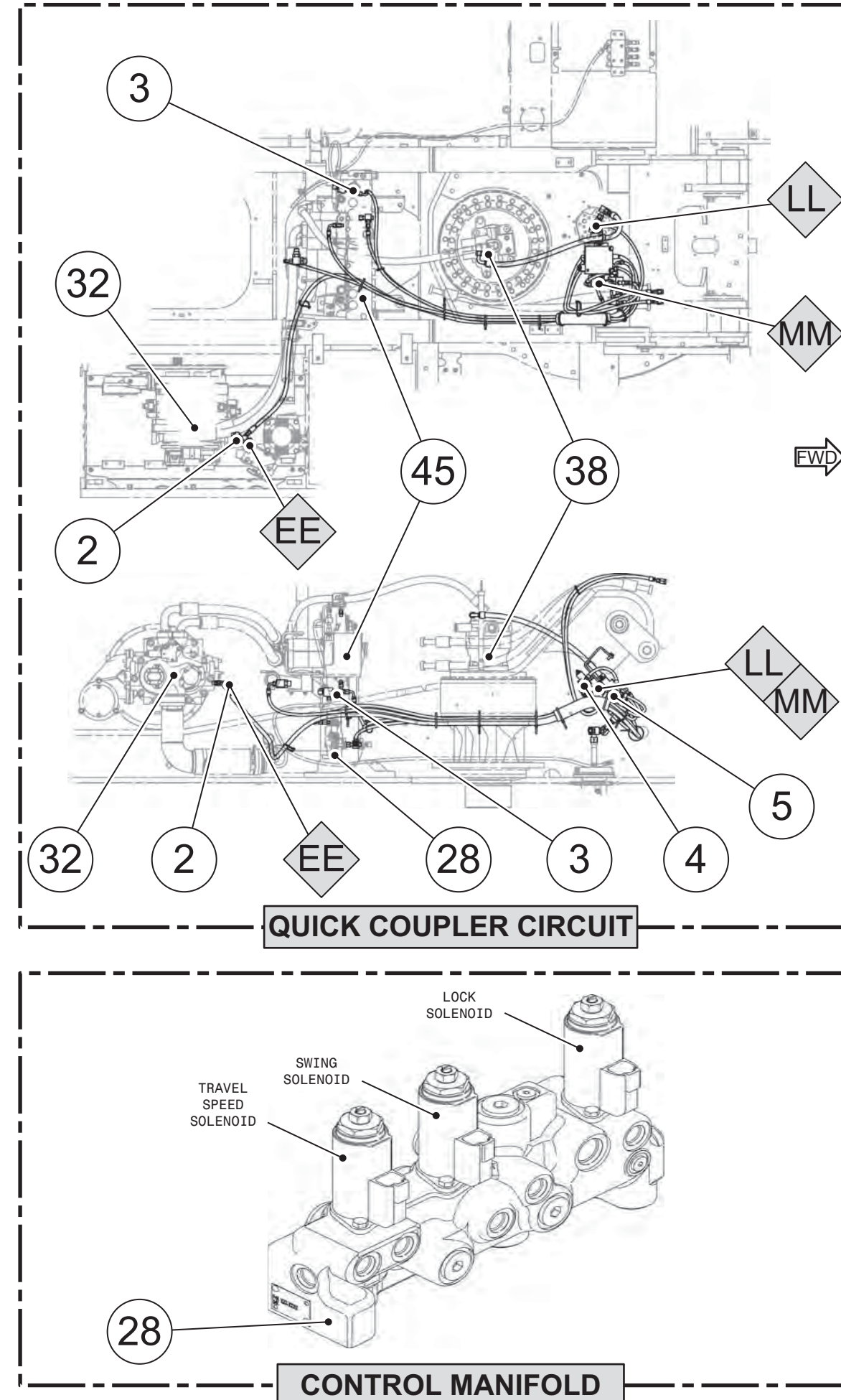

Schematic

320D, 321D, 323D, 324D, 325D, 329D 330D, 336D, and 336D MHPU Excavator Hydraulic System - Attachment

- | | | | | | |
|-------------------------------------------------------------------------------------------------------------------------------------------------------------|-----------------------------------------------------------------------------------------------------------------------------------------------------------------------------------|-------------------------------------------------------------------------------------------------------------------------------------------------------------------------------------------------------|-----------------------------------------------------------------------------------------------------------------|------------------------------------------------------------------------------------------------------|-----------------------------------------------------------------------------------------------------------------|
| 320D:
A6F1-UP
A8F1-UP
A9F1-UP
KGF1-UP
MCH1-UP
TDH1-UP
FAL1-UP
KLM1-UP
SPN1-UP
WBN1-UP
GDP1-UP
PCX1-UP
PHX1-UP | 323D:
RAC1-UP
SDC1-UP
WGC1-UP
CYD1-UP
SED1-UP
YSD1-UP
NDE1-UP
WNE1-UP
ZMF1-UP
JLG1-UP
BYM1-UP
PBM1-UP
NES1-UP
DKW1-UP
SBZ1-UP | 324D:
EJC1-UP
MND1-UP
T2D1-UP
JJG1-UP
BTK1-UP
SYM1-UP
JAT1-UP
325D:
GPB1-UP
PKE1-UP
LAL1-UP
MCL1-UP
AZP1-UP
A3R1-UP
GBR1-UP
T2S1-UP
CYW1-UP | 329D:
XDB1-UP
BFC1-UP
JBF1-UP
JBD1-UP
WDM1-UP
EBM1-UP
YFM1-UP
SCY1-UP
DTZ1-UP | 330D:
GGE1-UP
B6H1-UP
LRM1-UP
JLP1-UP
MWP1-UP
RAS1-UP
EDX1-UP
T2Y1-UP | 336D:
LMG1-UP
MYG1-UP
WRK1-UP
PPN1-UP
MYP1-UP
JWR1-UP
DTS1-UP
WET1-UP
PGW1-UP |
|-------------------------------------------------------------------------------------------------------------------------------------------------------------|-----------------------------------------------------------------------------------------------------------------------------------------------------------------------------------|-------------------------------------------------------------------------------------------------------------------------------------------------------------------------------------------------------|-----------------------------------------------------------------------------------------------------------------|------------------------------------------------------------------------------------------------------|-----------------------------------------------------------------------------------------------------------------|

Universal Quick Coupler

© 2010 Caterpillar, All Rights Reserved

Printed in U.S.A.

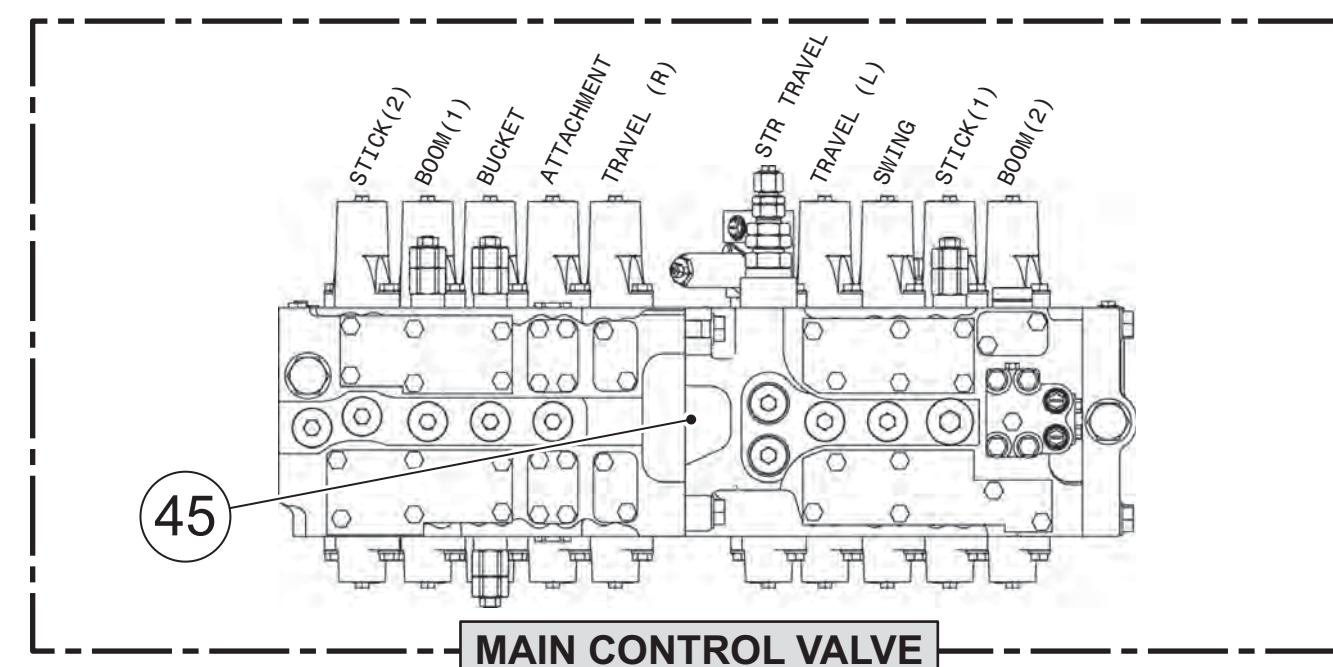
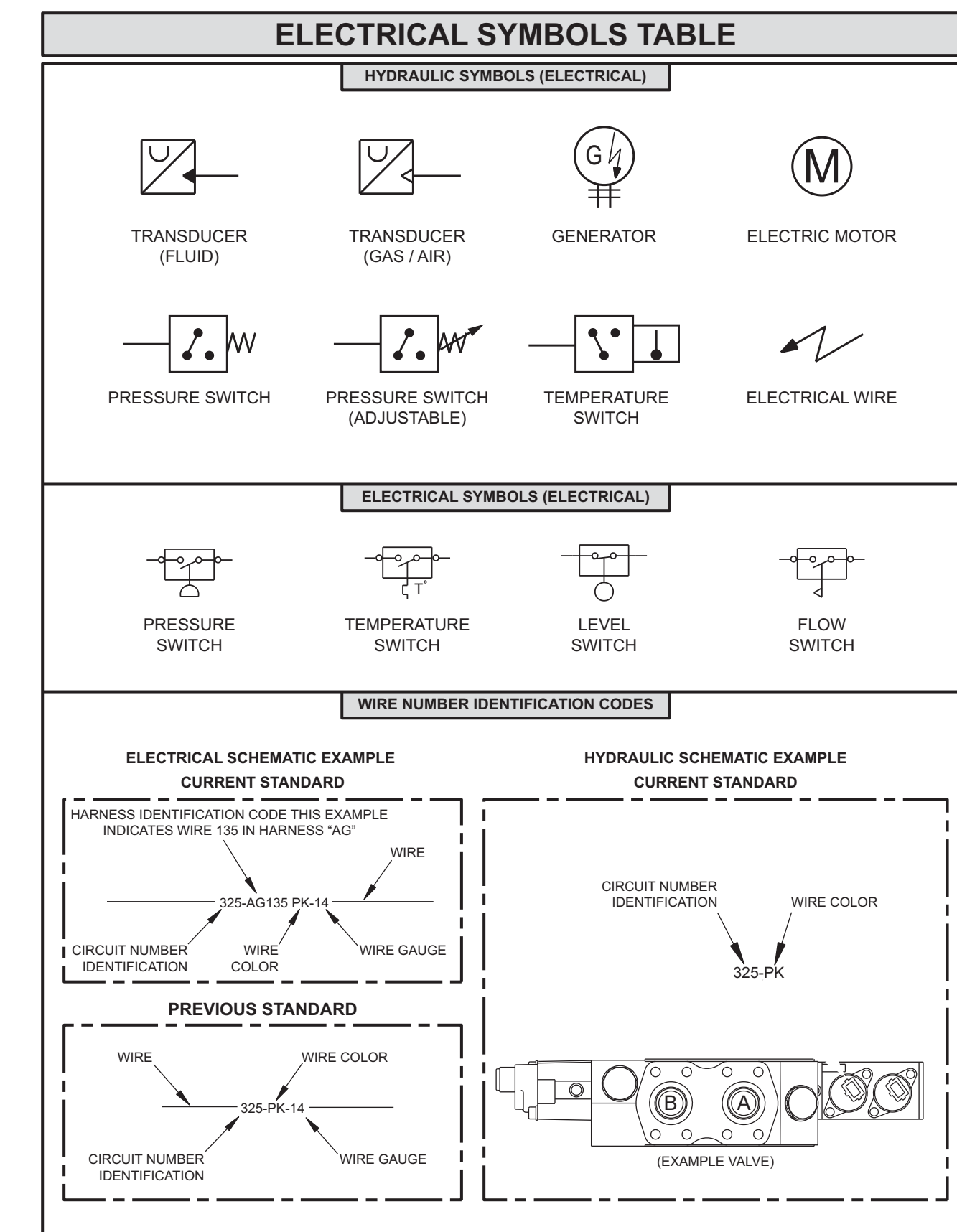
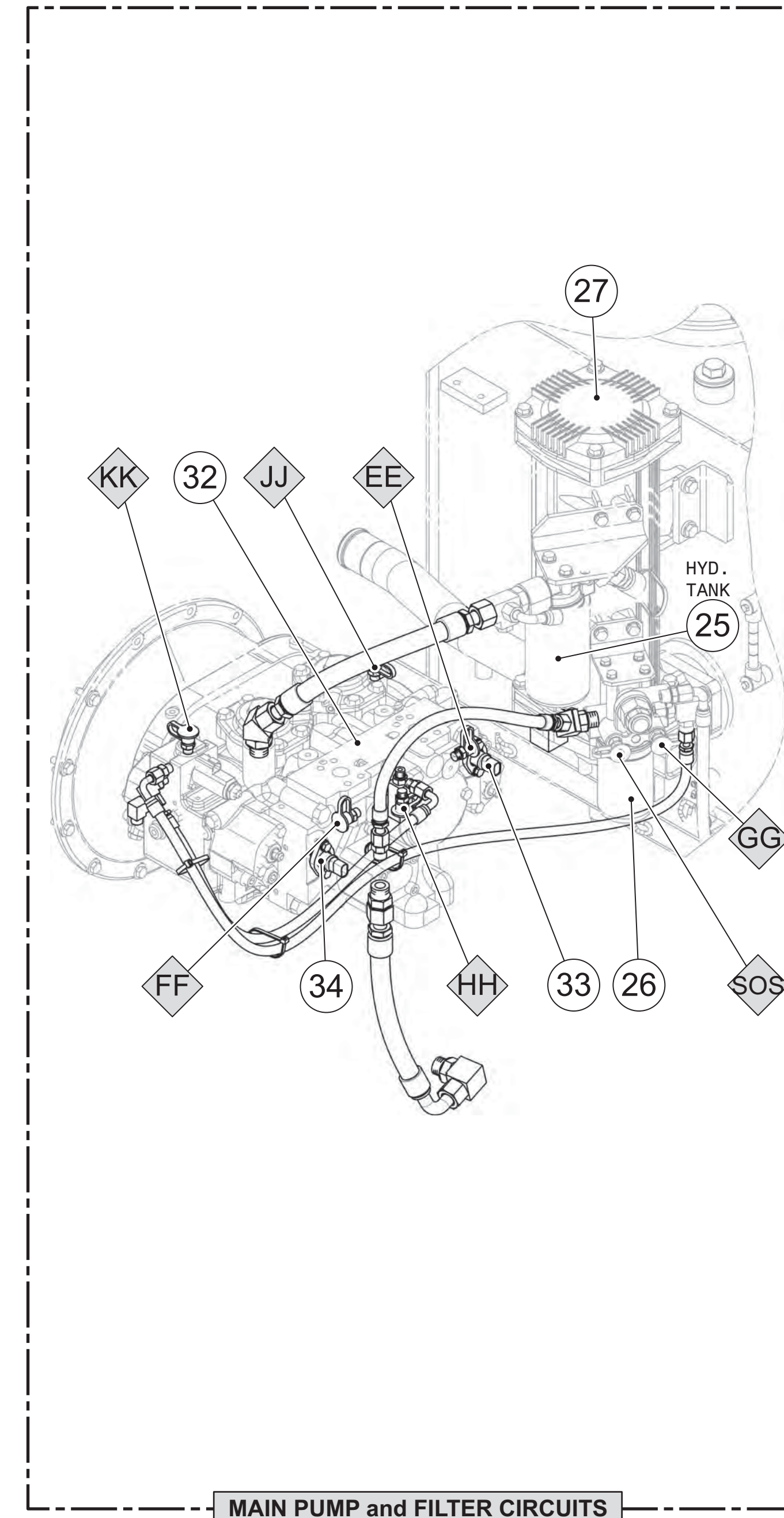
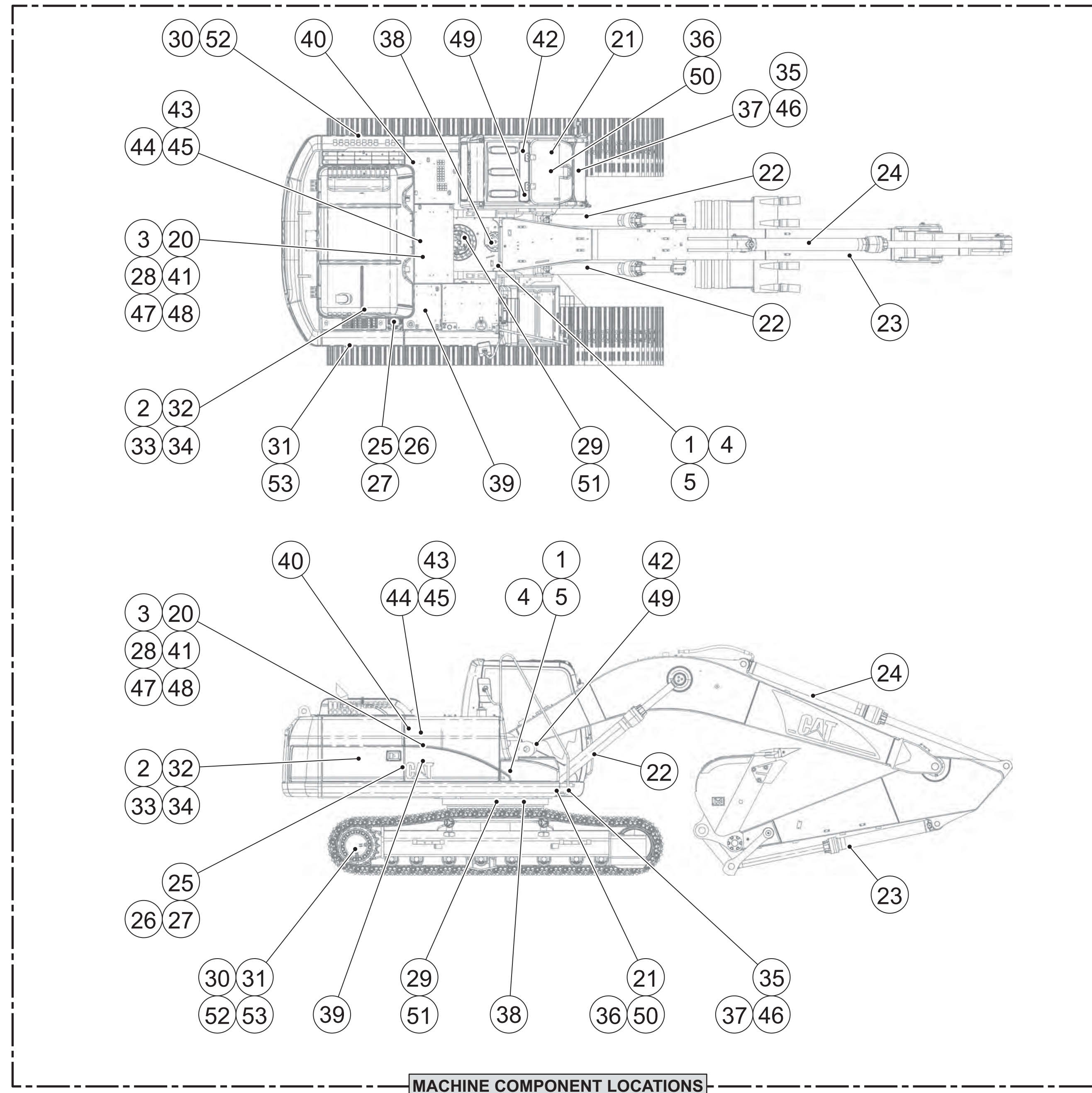
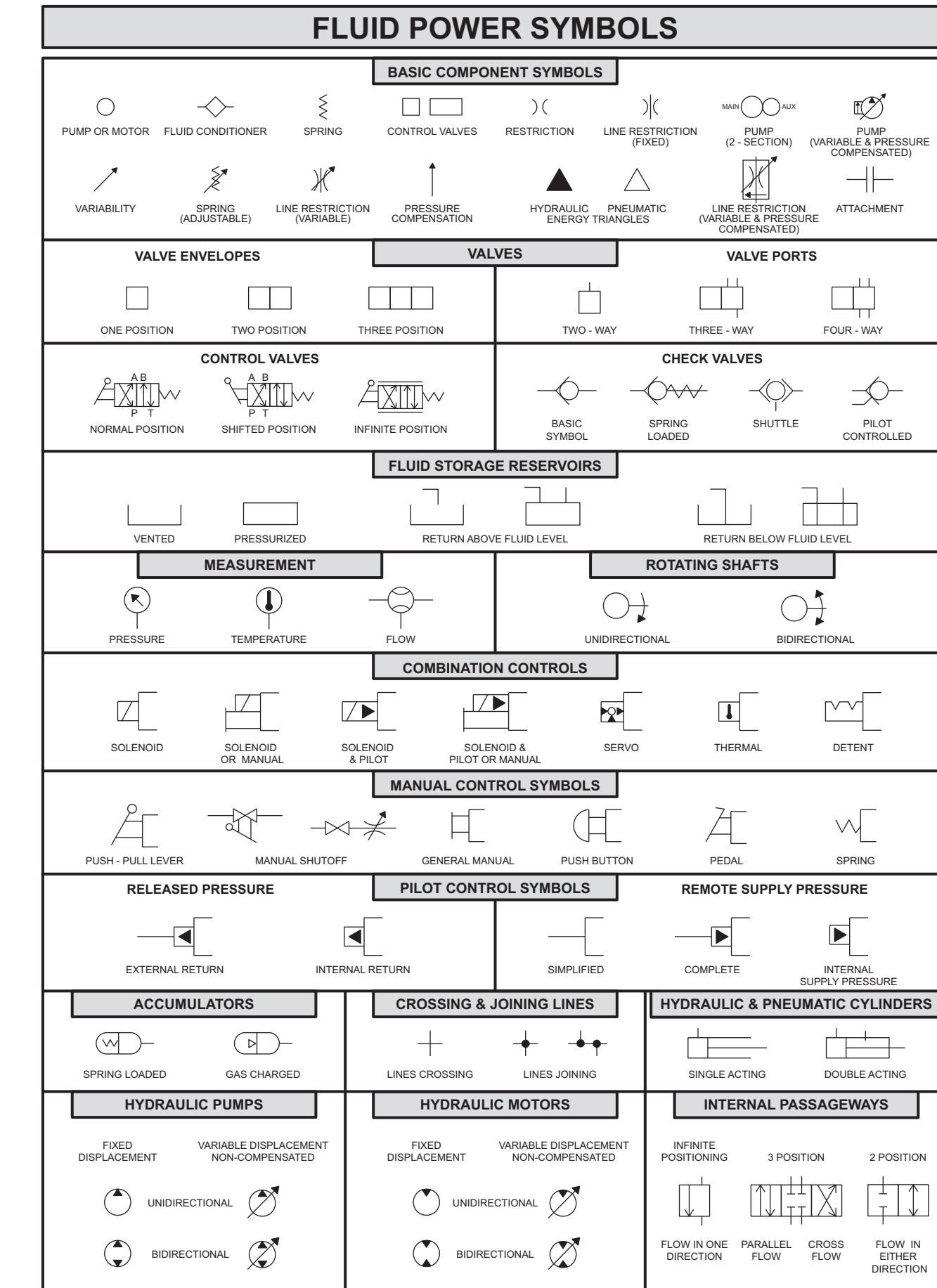

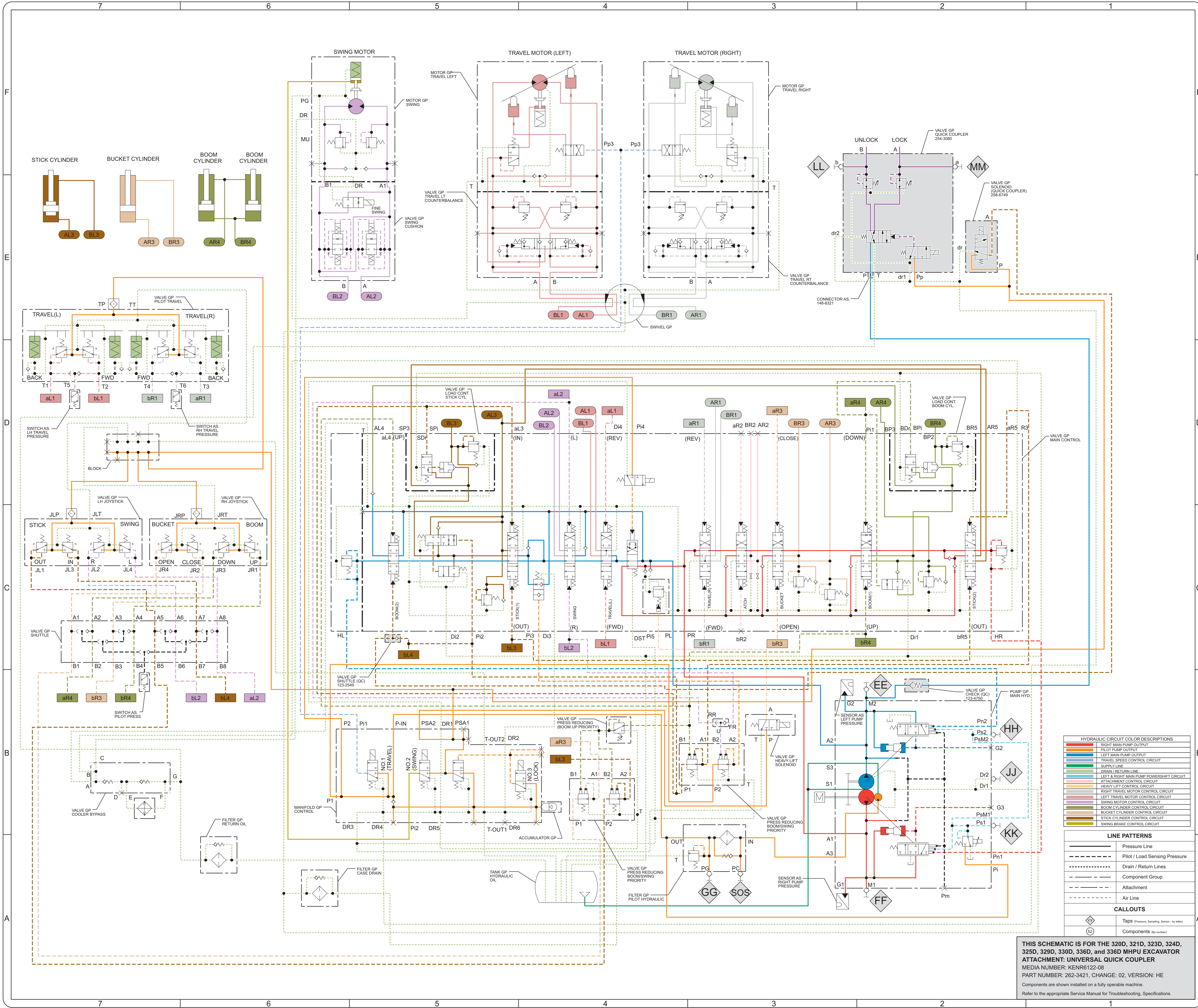

THIS SCHEMATIC IS FOR THE 320D, 321D, 323D, 324D, 325D, 329D, 330D, 336D, and 336D MHPU EXCAVATOR ATTACHMENT: UNIVERSAL QUICK COUPLER
 MEDIA NUMBER: KENR6122-08
 PART NUMBER: 262-3421, CHANGE: 02, VERSION: HE
 Components are shown installed on a fully operable machine.
 Refer to the appropriate Service Manual for Troubleshooting, Specifications.