



Schematic

248

**Skid Steer Loader
Hydraulic System**

6LZ1-UP

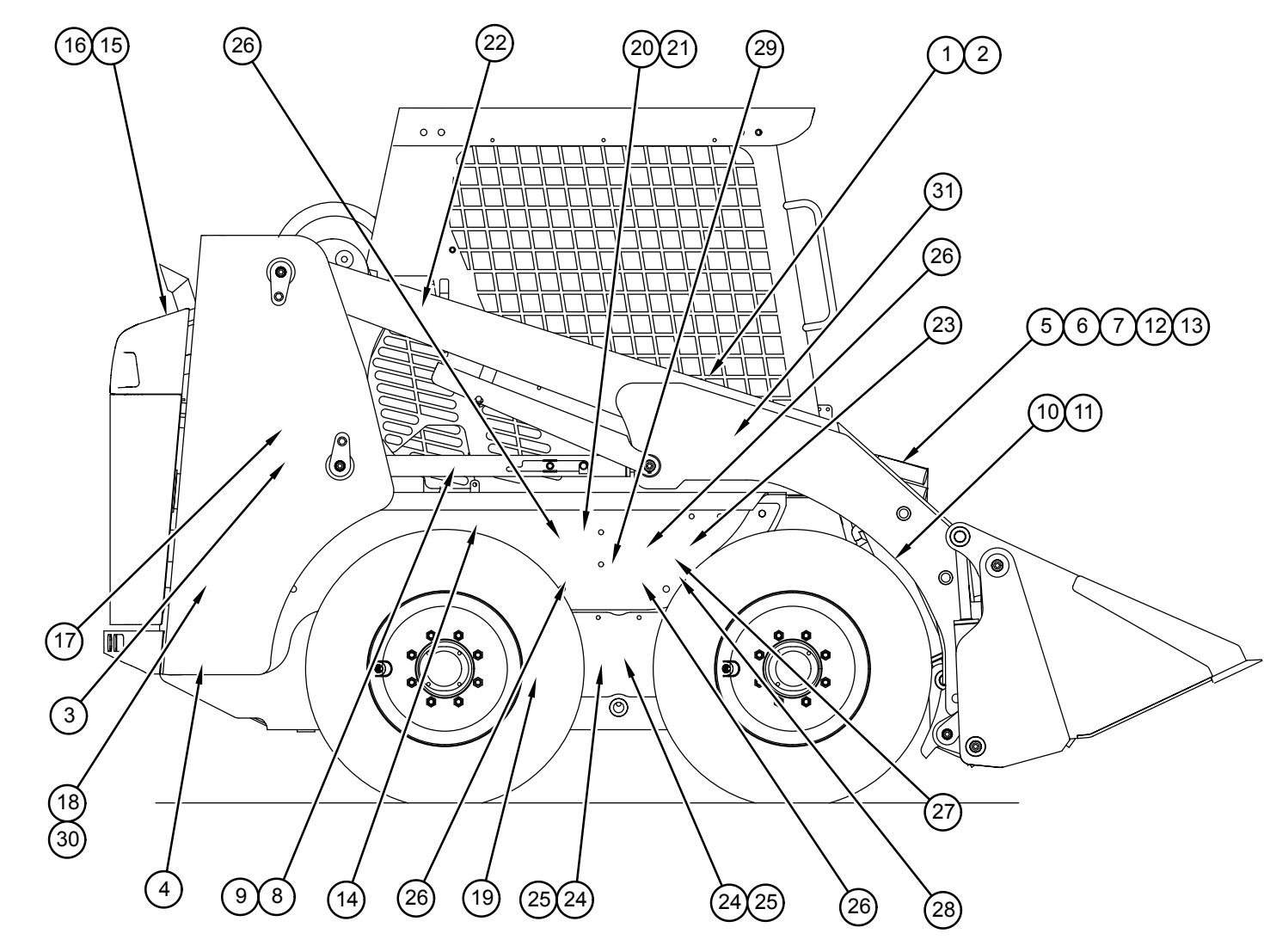
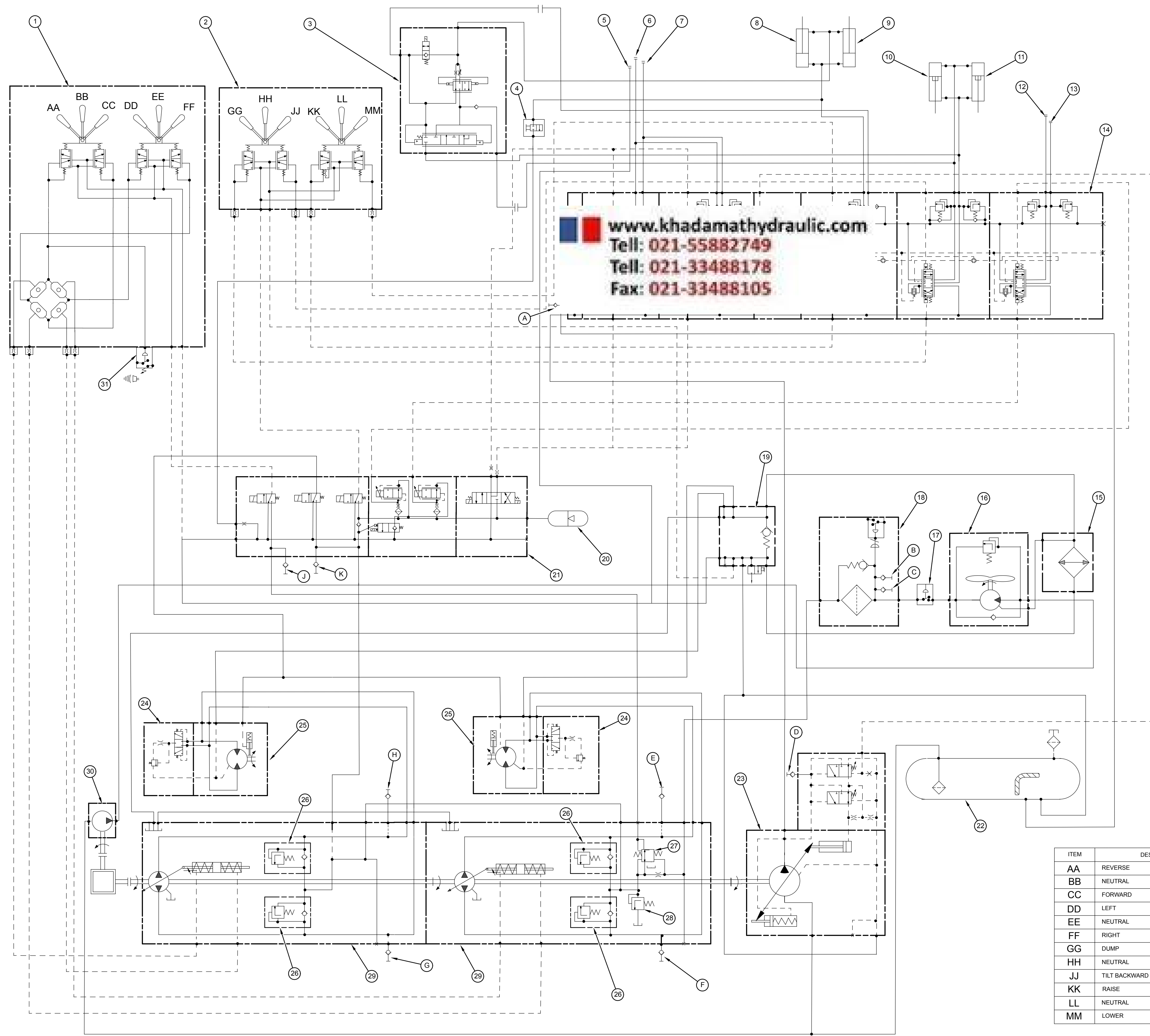

STANDARD COMPONENTS	
ITEM	DESCRIPTION
1	JOYSTICK CONTROL (HYDROSTATIC)
2	JOYSTICK CONTROL (WORKTOOL)
3	DIVERTER VALVE
4	BALL VALVE (LOCATED ON THE LEFT SIDE OF MACHINE)
5	COUPLING FOR HIGH FLOW AUXILIARY TOOLS (LOCATED ON LEFT SIDE OF MACHINE)
6	COUPLING FOR HIGH FLOW AUXILIARY TOOLS (LOCATED ON LEFT SIDE OF MACHINE)
7	COUPLING FOR HIGH FLOW AUXILIARY TOOLS (LOCATED ON LEFT SIDE OF MACHINE)
8	LIFT CYLINDER
9	LIFT CYLINDER
10	TILT CYLINDER
11	TILT CYLINDER
12	COUPLING FOR STANDARD FLOW AUXILIARY TOOLS (LOCATED ON LEFT SIDE OF MACHINE)
13	COUPLING FOR STANDARD FLOW AUXILIARY TOOLS (LOCATED ON LEFT SIDE OF MACHINE)
14	BANK VALVE
15	HYDRAULIC OIL COOLER
16	FAN MOTOR
17	ENGINE CUT OFF PRESSURE SWITCH
18	HYDRAULIC OIL FILTER
19	RETURN MANIFOLD ASSEMBLY
20	ACCUMULATOR (LOCATED ON LEFT SIDE OF MACHINE)
21	INTERLOCK MANIFOLD (LOCATED ON THE LEFT SIDE OF MACHINE)
22	HYDRAULIC TANK
23	WORK TOOL PISTON PUMP
24	MOTOR FLUSHING VALVE
25	MOTOR
26	CROSS OVER RELIEF VALVE
27	SPEED SENSING VALVE
28	CHARGE PRESSURE RELIEF VALVE
29	HYDROSTATIC PISTON PUMP
30	CHARGE PUMP
31	BACKUP ALARM PRESSURE SWITCH (LOCATED ON LEFT SIDE OF MACHINE)

ITEM	DESCRIPTION
AA	REVERSE
BB	NEUTRAL
CC	FORWARD
DD	LEFT
EE	NEUTRAL
FF	RIGHT
GG	DUMP
HH	NEUTRAL
JJ	TILT BACKWARD
KK	RAISE
LL	NEUTRAL
MM	LOWER

PRESSURE TAPS	
ITEM	DESCRIPTION
A	PUMP DISCHARGE PRESSURE (LOCATED ON BANK VALVE)
B	SCHEDULED OIL SAMPLING PORT
C	FILL PORT (PUMP PRESSURE BEFORE THE FILTER)
D	(LS) LOAD SENSING PRESSURE
E	(MB2) MAIN DRIVE LOOP PRESSURE FOR THE REAR PUMP
F	(MA2) MAIN DRIVE LOOP PRESSURE FOR THE REAR PUMP
G	(MB1) MAIN DRIVE LOOP PRESSURE FOR THE FRONT PUMP
H	(MA1) MAIN DRIVE LOOP PRESSURE FOR THE FRONT PUMP
J	(PS2) SPEED SENSING SIGNAL PRESSURE
K	(PS1) CHARGE PRESSURE